

Application: all industrial applications. Indispensable for high fit in assembly.
 Mounting: by means of specific tools.

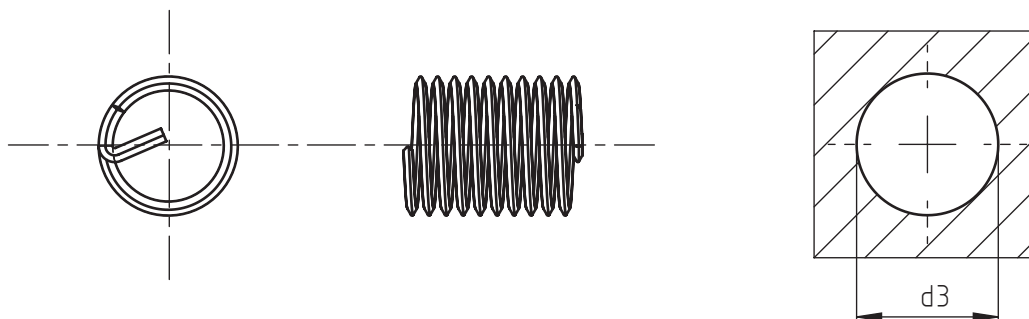

code	metric thread	hole diameter	nominal lenght fitting thread code				
	diam. x pitch	d 3	1 D	1,5 D	2 D	2,5 D	3 D
02x40x	M 2 x 0,4	2,1	2	3	4	5	6
02,5x45x	M 2,5 x 0,45	2,6	2,5	3,75	5	6,25	7,5
03x50x	M 3 x 0,5	3,2	3	4,5	6	7,5	9
03,5x60x	M 3,5 x 0,6	3,7	3,5	5,25	7	8,75	10,5
04x70x	M 4 x 0,7	4,2	04	06	08	10	12
05x80x	M 5 x 0,8	5,2	05	07,5	10	12,5	15
06x100x	M 6 x 1	6,3	06	09	12	15	18
07x100x	M 7 x 1	7,3	07	10,5	14	17,5	21
08x100x	M 8 x 1	8,3	08	12	16	20	24
08x125x	M 8 x 1,25	8,4	08	12	16	20	24
10x100x	M 10 x 1	10,25	10	15	20	25	30
10x125x	M 10 x 1,25	10,4	10	15	20	25	30
10x150x	M 10 x 1,5	10,5	10	15	20	25	30
12x125x	M 12 x 1,25	12,4	12	18	24	30	36
12x150x	M 12 x 1,5	12,5	12	18	24	30	36
12x175x	M 12 x 1,75	12,5	12	18	24	30	36
14x125x	M 14 x 1,25	14,4	14	21	28	35	42
14x150x	M 14 x 1,5	14,5	14	21	28	35	42
14x200x	M 14 x 2	14,5	14	21	28	35	42
16x150x	M 16 x 1,5	16,5	16	24	32	40	-
16x200x	M 16 x 2	16,5	16	24	32	40	48

Non binding dimensions, expressed in mm.
 Other metric thread available, UNC, UNF, Whitworth, Gas available on request.
 Ask the office technical documentation, including tables codification of items required for assembly of the respective threads Filtec.

Standard
 On demand
 Not manufactured

Material: stainless steel X 5 Cr Ni 1809
 bronze - inconel - nimonic on request
 Example: filtec thread, stainless steel M 5x 0,8 lenght,
 fitted thread 7,5 mm. (1,5 D): 05 x 80 x 07,5

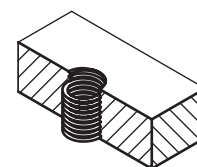

SPECIALINSERT - COMMITS ITSELF TO CONTINUOUSLY IMPROVE ITS PRODUCTS - IT RESERVES THE RIGHT TO CHANGE THEIR TECHNICAL AND STRUCTURAL CHARACTERISTICS WITHOUT PRIOR NOTICE - ALL RIGHTS ARE RESERVED AND THE DUPLICATE, EVEN PARTIAL OF THESE DOCUMENTS, AS WELL AS ITS DISTRIBUTION TO THIRD PARTIES, ARE FORBIDDEN, UNLESS OTHERWISE AND EXPRESSLY AUTHORIZED BY SPECIALINSERT.